

本圖面若與目錄之規格尺寸不符，以本圖面規格尺寸為主。
Below is our main specification if different from catalog.

RoHS compliant

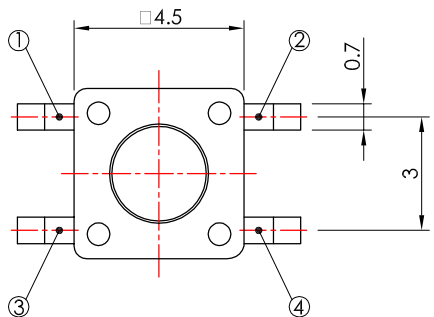

CIRCUIT DIAGRAM

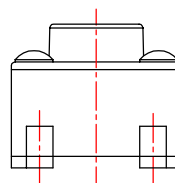
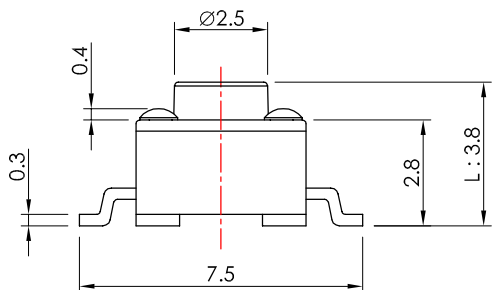
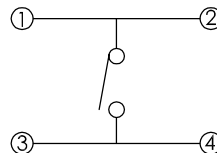

SMD REFLOW PATTERN

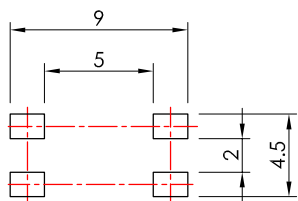

RoHS compliant

IT-1109S~~X~~-~~XXX~~G-G

MODEL NO.	L
□	3.8
A	7.0

OPERATING FORCE
160, 250

SPECIFICATION

- Rating:** 50mA 12V DC Max.
- Circuit:** SPST.
- Travel:** 0.25±0.1mm.
- Contact resistance:** 100mΩ Max. (initial)
- Operating force:** 160±50G.
- Minimum load:** 10mA 3.3V DC. (reference only)
- Operating life:** 100,000 Cycles Min.
- Soldering temperature:** 250°C Max for 3 Sec.
- Soldering time:** 1 time only.
- Note:** Not washable, don't immerse into epoxy and organic solvent.



IV3.1	△		
IV3.0	無	新繪製	2008.12.04
版本 VER.	符號 SYMBOL	修改內容 ALTERATION	更新日期 DATE

產品 PRODUCT		Tact Switch		型號 MODEL NO.		IT-1109S-160G-G	
比例 SCALE	5 : 1	單位 UNIT	mm	<p>一綺電子企業股份有限公司</p> <p>總公司：110 台北市信義路四段415號12樓之2 12F-2 NO. 415, SEC. 4, HSIN YI ROAD, TAIPEI, TAIWAN TEL : 886-2-27290229 (Rep.) FAX : 886-2-27582086 URL : http://www.switronic.com.tw E-MAIL : switches@ms36.hinet.net</p>			
公差 TOLERANCE	±0.3mm						
製圖 DRAWN BY	核圖 CHECKED BY	主管 APPROVED BY					
San Chiu	Alex Lin	Margaret Lee					